

St. Paul, Minn., August 5, 1944.

Equipment-Locations  
Staples  
Relocate Strike Camp Bldgs.

2486

Mr. C. C. Kyle:

Attached please find three copies of list of electrical material left over from installing electric service lines for strike camp buildings located at Staples, Minn., AFE 6-24, job #1222.

This left over material was turned over to the Division Storekeeper at Staples, Minn., on July 8.

Please arrange to credit the above job and charge the proper account with the value of this left over material.

C  
cc Mr. E. J. Hackenberg  
Mr. R. G. Becker  
Mr. F. C. Sharood  
Mr. A. J. Blom

*C. J. Enslin*  
Mechanical Engineer.

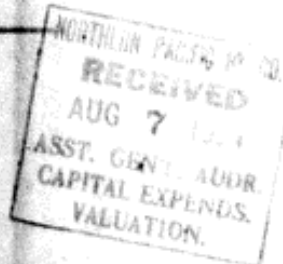

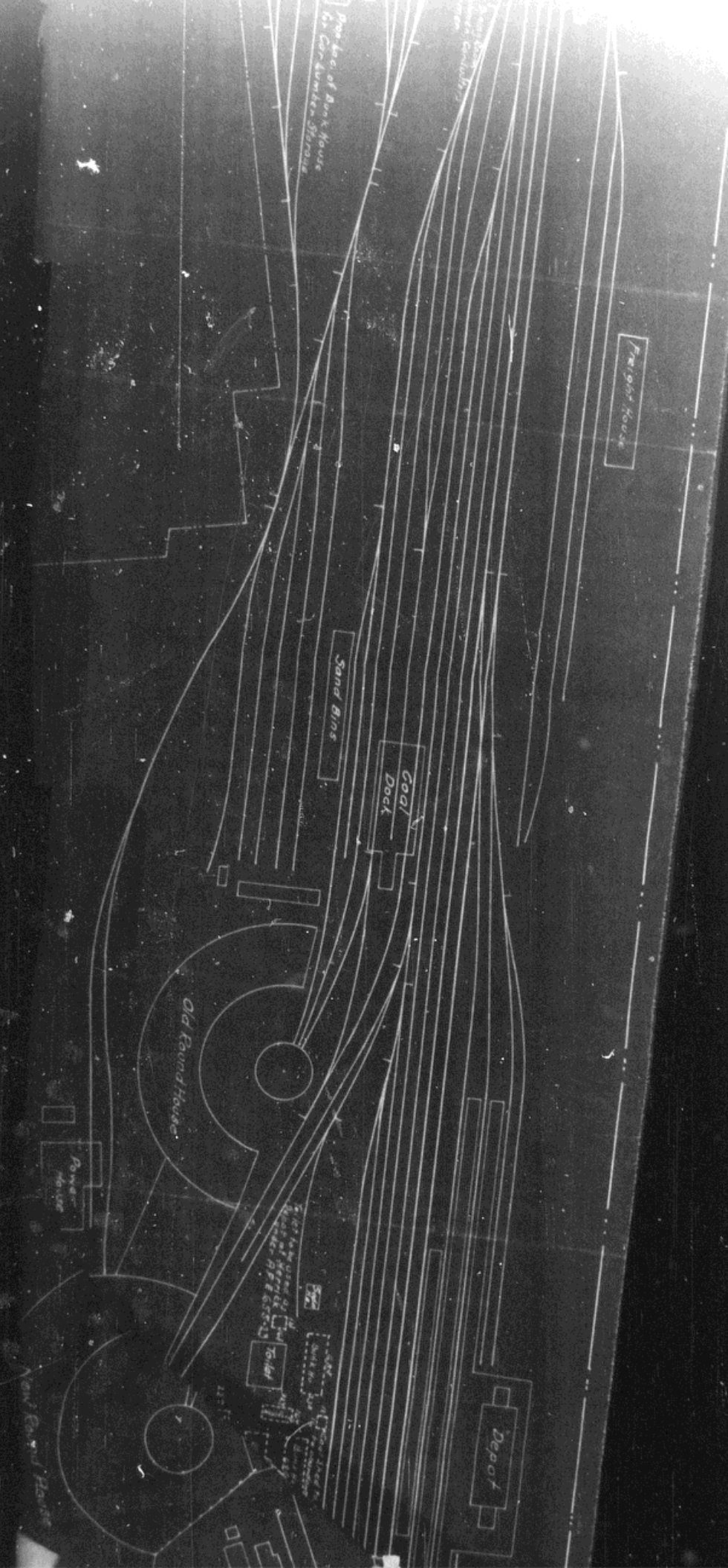

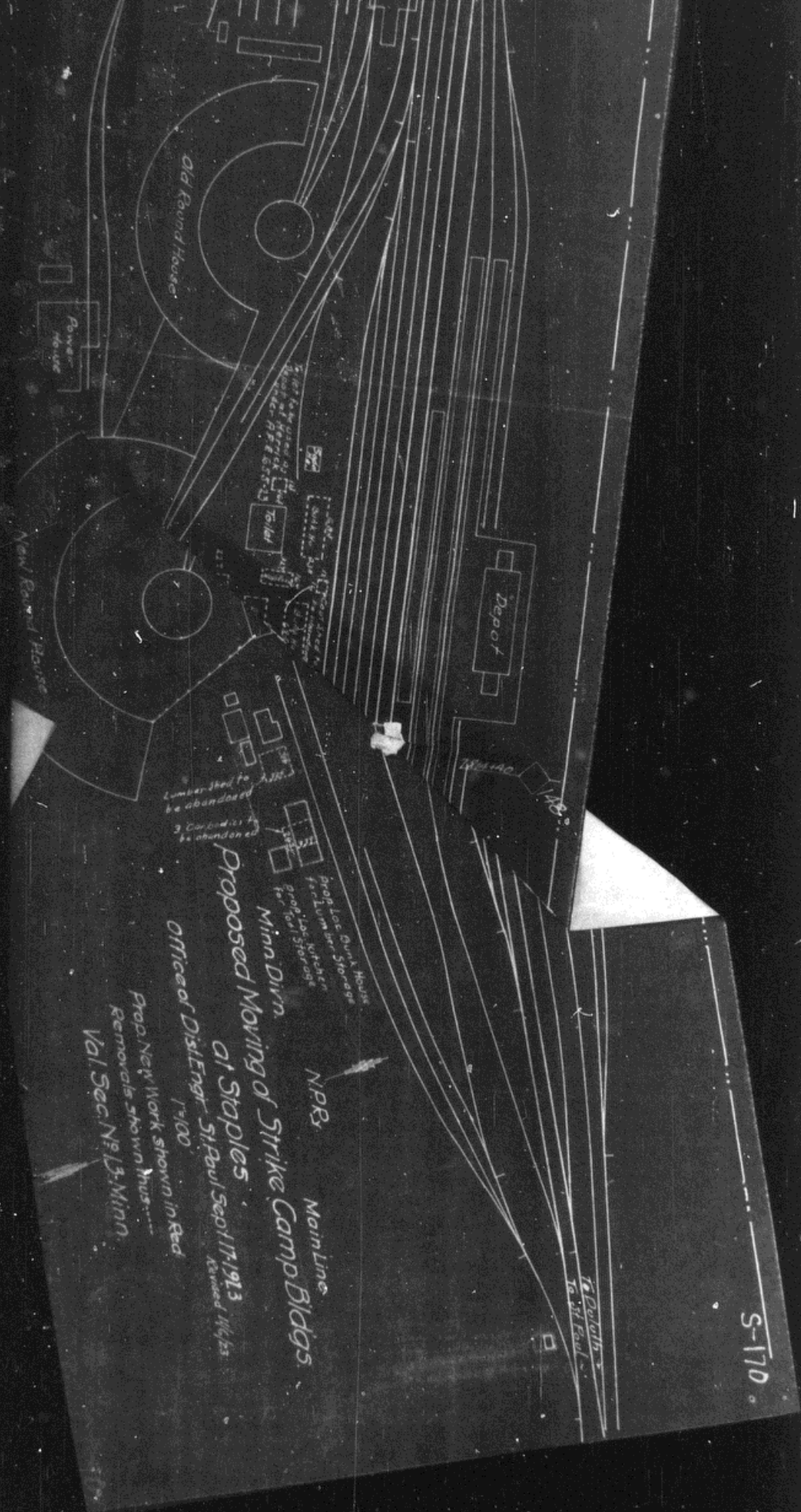

Old Round House

Power House

New Round House

Depot

Prop. Los Duro House  
for lumber storage  
for local storage

Minn. Divn.  
of Staples

Office of Dist Engr  
St. Paul Sep 17, 1913  
Assumed 1912/23

Prop. New Work shown in Red  
Removals shown in Blue  
Vol. Sec. No. 13, Minn.

NPRs

Main Line

Proposed Moving of Strike Camp Bldgs.

S-170

To Parkville  
To St Paul

# NORTHERN PACIFIC RAILWAY COMPANY.

## FIELD COMPLETION REPORT.

Owner **N.P.RY.**  
 Lessee  
 Operating Co. **N.P.RY.**

GENERAL ACCOUNTS  
 I. ROAD, AND  
 III. GENERAL EXPENDITURES.

Completion Report  Progress  Final No. 1

A. F. E. No. 6-24  
 Date Authorized 1-10-24  
 Sheet No. 1 of 4 Sheets

Location of Project; State **Minnesota** Valuation Section **13** {Station or M. P.} **Staples** Division **Minnesota**  
 Description of Project **STORAGE BUILDINGS ETC. OLD STRIKE CAMP BLDGS.**

Work Begun **December 1923**, Portion here reported {Turned over to} Operation  
 {Retired from} Project Completed **July 17, 1924**  
 Project {Turned over to} Operation **July 17, 1924**  
 {Retired from} Under Supervision of **Division Supt. (District Engr.)**  
 Name of Contractor on original const. **(Foley Bros. St. Paul)** Date of Contract **July 26, 1922**  
 Work done by **Division Forces (Contractor)** **NOT JOINT**  
 Name of Contractor on original const. **(Foley Bros. St. Paul)**  
 Cost borne by **N.P.RY.**

PROPERTY UNITS ADDED; THE AGGREGATE OF THEIR COSTS IN PLACE; COST OF EFFECTING PROPERTY RETIREMENTS

DESCRIPTION OF PROPERTY AND CONSTITUENT PARTS.

PROPERTY AND COSTS RETIRED.

UNIT	NO. OF UNITS	COST	Charge Acct. No.	DESCRIPTION OF PROPERTY AND CONSTITUENT PARTS.	UNIT	NO. OF UNITS	COST	Credit Acct. No.
		79.83	1	<b>ENGINEERING</b>  This AFE covers the moving of the old Strike Camp Buildings at Staples to various locations. In the new locations the buildings were placed on concrete or stone block foundations and the changes made in the buildings are noted in the body of the report.  Following is a description of the buildings as originally constructed. Sills 6"x8" Floor joists 2"x6" 2' C-C Floor 1" rough boards & 1"x6" DAM Studs 2"x4" 2' C-C Exterior walls 1" Shiplap & 1" drop siding Interior " 1" bead ceiling on walls & ceiling Rafters 2"x6" 2' C-C Roof boards 1" shiplap Roof Rubberoid roofing  Following is a description of the changes made in the various buildings:				
Each	1	1954.61	16	<b>STATION AND OFFICE BUILDINGS</b> Dining Room moved near Yard Office for Trainmen and Carmen Structure 23.8x68.5 Door in East end removed Siding placed on portion of side where kitchen was out away. Two doors placed in side of building Two partitions placed dividing building into three rooms for Carmen, Trainmen and Switchmen and lockers placed in each room. A caboose stove placed in switchmen's and carmen's room. Labor 847.41 Material 1107.20				
G.Y.	0.91	11.68		Foundation - concrete blocks Labor 5.10 Material 6.58				
MFBM	2.062	414.25		Addl. lumber used in building Labor 324.65 Material 89.60				
Lbs.	90	4.59		Iron Caboose stoves				
Each	2	52.15		Freight Lumber from Centralia 42.89 Hardware from St. Paul 1.46				
G.Y.	0.40	2.93		Old Carmen's house moved to location shown in yellow on sketch. Foundation - concrete blocks Freight from St. Paul .49				

# PACIFIC RAILWAY COMPANY.

## FIELD COMPLETION REPORT.

### CONTINUATION SHEET.

Completion Report ~~Progressive~~ Final No. 1

A F E No. 6-24

PROPERTY AND COSTS RETIRED

			DESCRIPTION OF PROPERTY AND CONSTITUENT PARTS.	UNIT	NO. OF UNITS	COST	Credit Acct. No.
		17	ROADWAY BUILDINGS				
			Bunk House moved to Rail Yard				
C.Y.	175	78.03	Grading - sand from Darling 5 cars 35 yds.				
			Labor 72.78				
			Material 5.25				
"	80	27.00	Cinders from Staples				
"	1.65	27.41	Foundation - concrete blocks				
			Labor 22.97				
			Material 4.64				
Each	1	2339.60	Structure above foundation 68.5'x23.8'				
			Labor 968.00				
			Material 1371.60				
			Bunk House				
			Center partition and lockers removed				
			2- 6" smoke jacks, galv. iron left in place				
			2 -12" Ventilators " " " "				
			Floor removed from 46' of building leaving				
			21.6' of wood floor in East End.				
			Space where floor was removed was filled				
			with cinders.				
		10.97	Freight				
			Cement blocks from St. Paul .78				
			Sand from Darling 10.19				
		878.54	Kitchen moved to B & B Yard and used for tool				
			storage. Kitchen was cut away from the				
			dining room and the end sided up with a				
			sliding door 6' wide.				
			Labor 360.20				
			Material 518.34				
C.Y.	0.91	4.88	Foundation - concrete blocks				
MPBM	0.537	32.05	New lumber used - addl.				
Lbs.	19	.29	Iron				
			Plumbing removed				
			Inside not ceiled				
		12.25	Freight				
			Cement blocks from St. Paul .84				
			Lumber from Centralia 11.41				
		2347.10	Bunk House moved to B & B Yard for Lumber Storage				
			Labor 968.00				
			Material 1377.10				
		15.77	Center partition removed				
			One end door removed and opening closed				
			3 - 5' doors and 1 - 7' doors (sliding) placed in side				
			Lumber racks constructed				
C.Y.	60	73.13	Cinders around building				
"	1.69	27.30	Foundation - blocks - stone				
			Labor 20.94				
			Material 6.36				
MPBM	1.015	73.88	Timber additional				
			Labor 46.68				
			Material 27.20				
Lbs.	20	.32	Iron				
		21.54	Freight				
			Lumber from Centralia 20.55				
			Hardware from St. Paul .01				
			Stone blocks - " .98				
			Old lumber shed in B & B Yard 31.6x32.5	Each	1		Orig. 17
			Car bodies in B & B Yard 26.4'x33.8'	"	3		changed 17
			Structure above foundation:	"	1		to 8400 17
			B & B Lumber Storage Shed 11.8'x16.2'				Optg. Expa. 17
			Height- rear 7.5' front 9.3', board and batten				
			Roof, 1" board walls, 2x4" studs, 2x6" purlins				
			4x6" sills 1" board floor on 4x6" mud sills.				
			1 door 3x6'-6" foundation timber	MPBM	.056		

*Handwritten notes:*  
MPBM  
0.537  
19

*Handwritten notes:*  
486.00  
17  
changed  
to 8400  
Optg. Expa.